

# FINNKAIHDIN.



## ROTA

Innovative concept - Intelligence & elegance adding to outdoor living spaces

Rota is taking its name from the rotational motion function and it is an aluminum bioclimatic system that enhances the aesthetics of your outdoor living areas with its high performance which enables you to create four seasons climate and ventilate the usage area thanks to its rotatable louvres.

Aluminum louvres come to an upright position, allowing you to ventilate your outdoor area to breathe and naturally regulate the temperature while protecting from any kind of weather conditions. The aluminium louvres can be stopped at the desired angle and the level of sunlight and airflow of the area can be easily adjusted.

System has a maximum width of 4 meters and projection of 6 meters and capable of covering various types of areas with flexible installation solutions.

System is harmonized with upgrades and creates a stunning touch for outdoor areas. It is equipped with hi-end technology combined with innovative concepts that converts any outdoor space into a comfortable and functional living area. System can create premium combinations with many structures with its minimalistic lines and finishes.

Rota fits perfectly in all architectural designs and presents endless modulation possibilities that enlarge terraces, gardens, hotels and restaurants with modern and timeless appearance.

SUNTECH

■ RGB Led-Hidden Stripe Lighting

■ Led Stripe Dimmer Lighting



**Led Stripe Dimmer Lighting** illuminates all around the system and creates a warm atmosphere. Dimmable Soft Led Stripe lighting on sides within the structure provides intensity of day light or cool white options.

**RGB Led-Hidden Stripe Lighting** provides ultimate luxury by creating distinctive atmosphere in outdoor living areas with infinite colour options.

## Operations

Fully Closed



Tilted



Tilted & Fully Closed



## Louvre Closing Direction

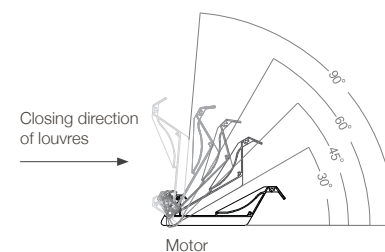

## Tilting Directions



Flexible installation methods are available with wall mounting and free standing installations and they can even be served as a roof assembled to existing frameworks.



Self Standing  
Single Module

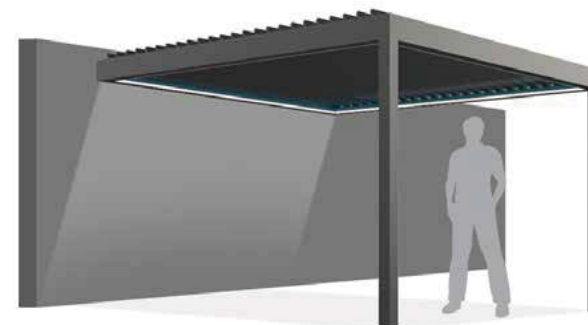

Wall Mounting  
Single Module



Self Standing  
Multiple Modules

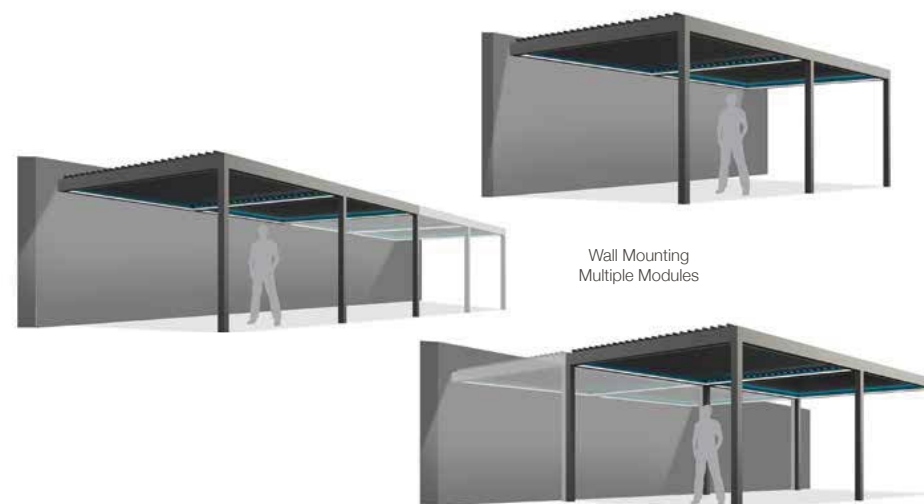

Wall Mounting  
Multiple Modules



Blocked assembly for customized modules with a wide range of flexible combinations.



(w) Width  
1000 mm < 4000 mm  
(p) Projection  
1134 mm < 6032 mm  
(h) Height  
3000 mm

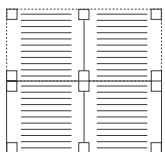
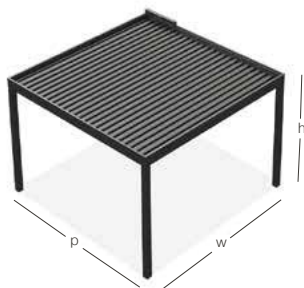

(w) Width  
2000 mm < 8000 mm  
(p) Projection  
2268 mm < 12064 mm  
(h) Height  
3000 mm

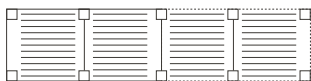
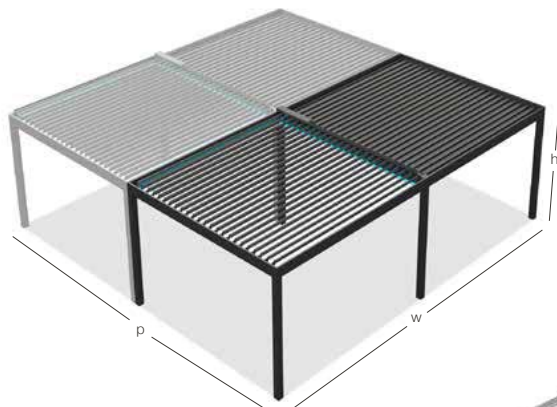

(w) Width  
4000 mm < 16000 mm  
(p) Projection  
1134 mm < 6032 mm  
(h) Height  
3000 mm

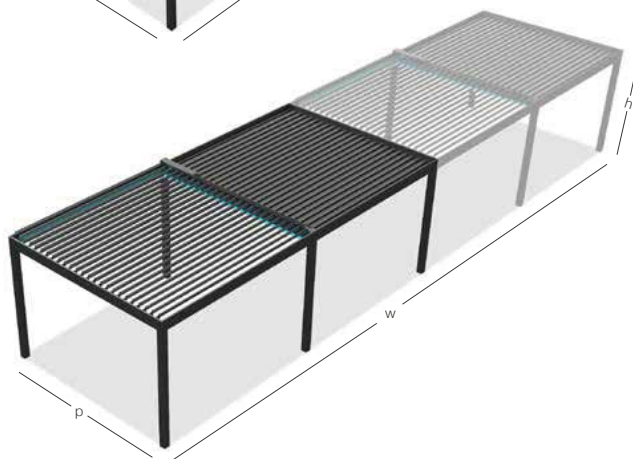

## Intra-Column Drainage Pipe

The water can be drained through internal drainage pipe and it eliminates factors that could block correct water flow. Intra-column drainage pipe collects the water and discharges to the ground.

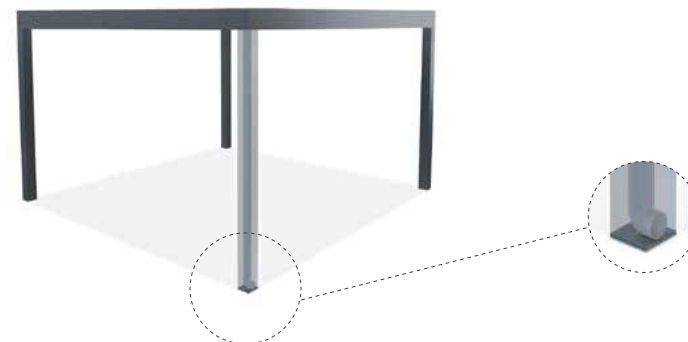
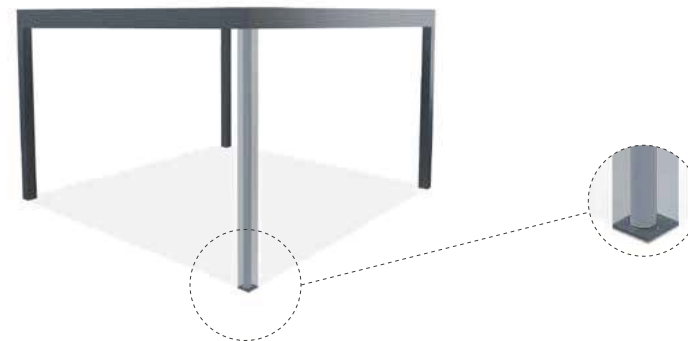

## Column Base Options

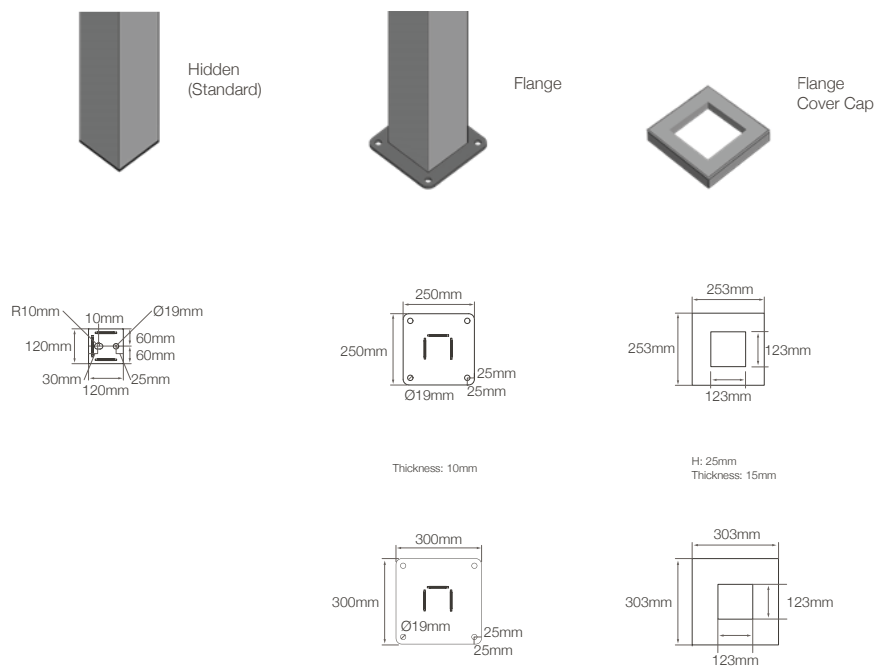

## Flange Positions

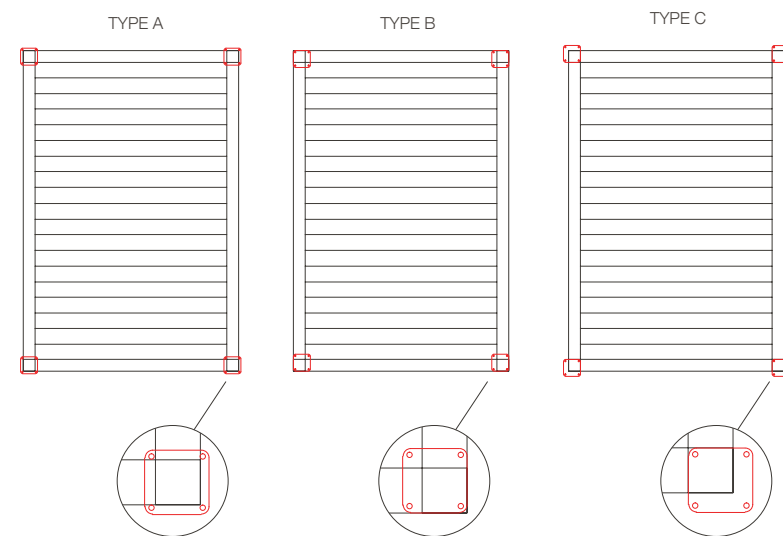

To be chosen only with flange option.

## Drainage Types

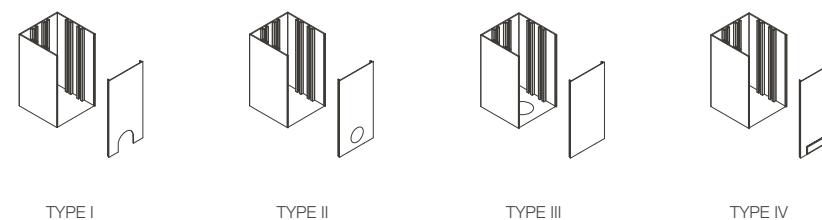

## Wall Installation Louvre Positions

Parallel To Wall

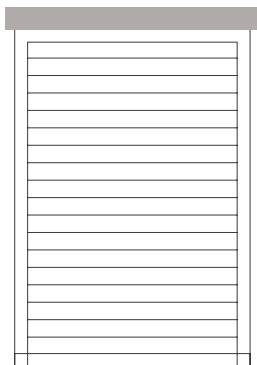

Vertical To Wall

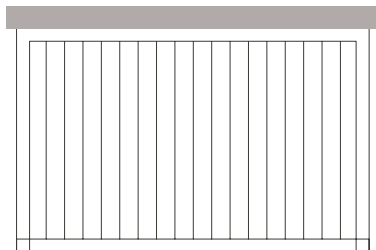

## Mounting

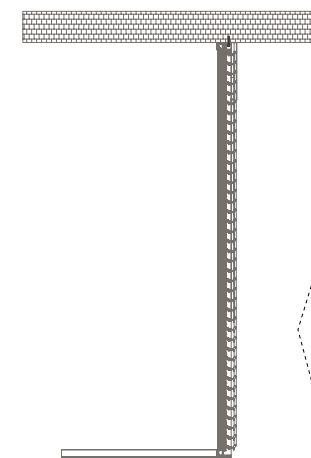
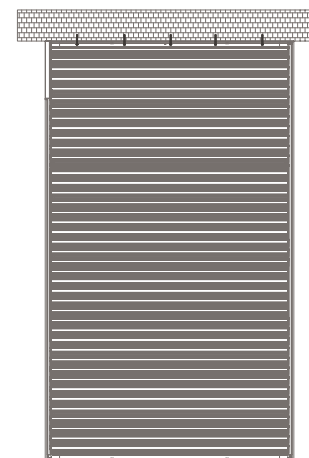

Easy wall mounting by screwing inox bolts through gutter profile. Any additional brackets are not required.

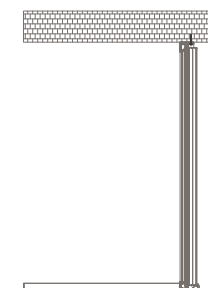
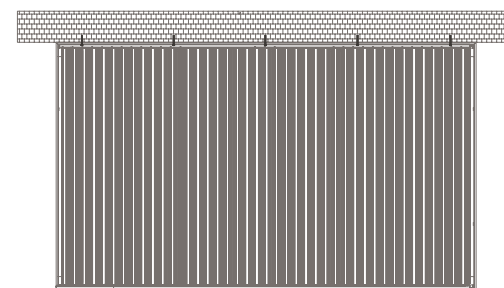

Side Elevation

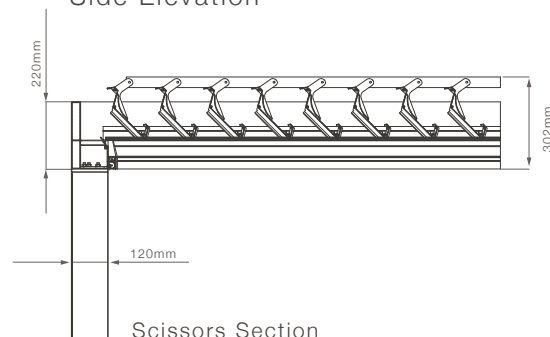

Scissors Section

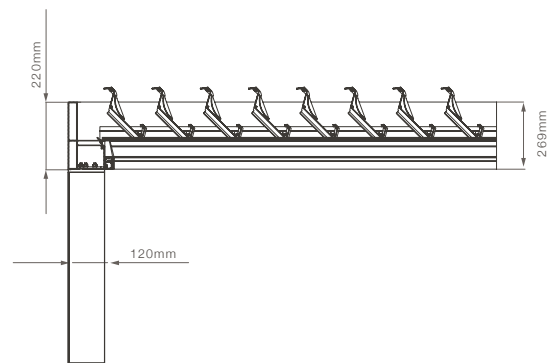

Column Connection

Thanks to ease of column base assembly each column can be installed practically through a series of simple operations that guarantee installation quality and speed to reduce number of staff required.

The front column cap can be pulled out simply and inner column cavity conceals the wiring cables of heater, speaker and automation to provide clean appearance.

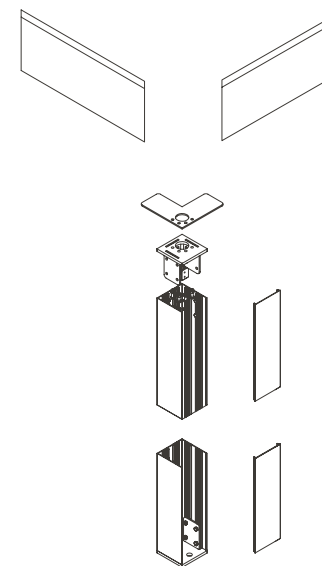

Louvre Stormguard Seal

Sealing solution stops water dripping over louvre gutter channel by providing a soft cushioning barrier between point of louvre junction.





Slightly opening of louvres creates natural air flow for application areas.



Ensuring waterproof coverage when louvres are in fully closed position.

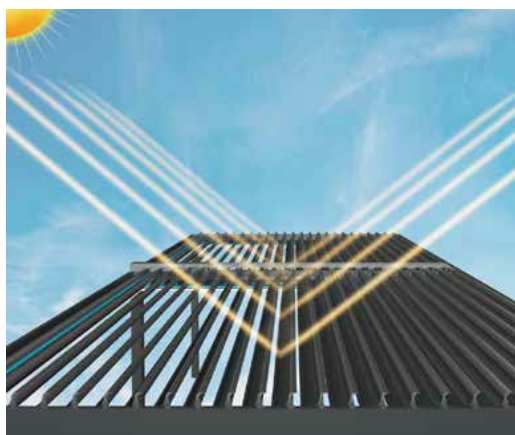

Protecting from sun exposure while ensuring air ventilation under the system .

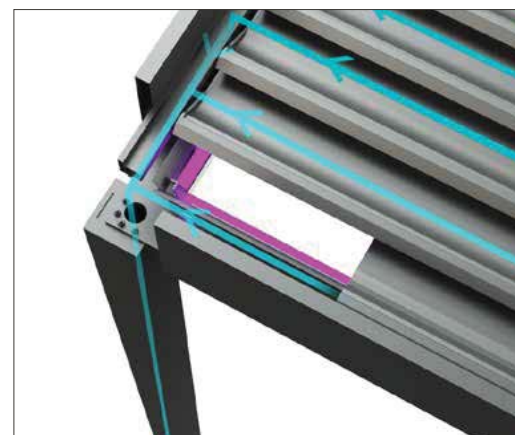

Each channel on louvres drain the water through four sided gutters connected with columns.



Functional seal integrated on louvre channels provides maximum protection from water dripping.

## Closures



### Sapphire Glass System

Sapphire can be adapted to Rota system and offers a maximum clear span that provides unobstructed view & minimalistic style. The system is operated by just the touch of button.



### Swind

Swind can be combined with also Rota system and offers adequate wind breaking with the option of total transparency by incorporating the function of balustrade. Thanks to led stripe dimmer lighting integrated side frame the fixed panel assigns distinctive appeal. The system is modular and completely flexible as there are no limits in the horizontal direction that can be used to surround spaces of all types and sizes.



### Violet

The adaptability of Violet balustrade glass with Rota creates a stunning visual transparency without lacking of obstruction to lines of sight. The stylish lighting solution that is integrated underneath the glass highlights attractive aspect of the design by amplifying overall aesthetic of outdoors. Thanks to flexible and multiple modular implementations, system can be used to cover comprehensive areas without limitation in the horizontal direction.



### Framee

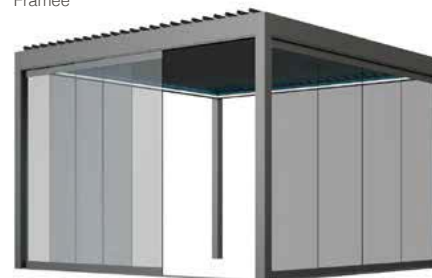

### Slidia

### Sliding Glass System

The combination of the sliding glass system with Rota ensures efficacious protection from wind and rain. The aluminium frames which cover each glass panel provide maximum safety standards and practicality with elegance details.



### Vertex Zip System

The minimalist, slimlane, contemporary design of the zip system provides comfortable shade and protects against the UV rays. The system includes motorised aluminium structure, entirely powder-coated with stainless steel bolts and screws.

### Dimension Ranges

Width dimension: Any customised values between 1800mm and 4000mm  
Projection dimension: Adjustable according to louvre quantity

		WIDTH									
		1800									4000
NR. OF LOUVRES	PROJECTION	6	1134								
		7	1292								
		8	1450								
		9	1608								
		10	1766								
		11	1924								
		12	2082								
		13	2240								
		14	2398								
		15	2556								
		16	2714								
		17	2872								
		18	3030								
		19	3188								
		20	3346								
		21	3504								
		22	3662								
		23	3820								
		24	3978								
		25	4136								
		26	4294								
		27	4452								
		28	4610								
		29	4768								
		30	4926								
		31	5084								
		32	5242								
		33	5400								
		34	5558								
		35	5716								
		36	5874								
		37	6032								

Single Module  
W: 1000 mm < 4000 mm  
P: 1134 mm < 6032 mm

Multiple Modules Joining Type 1  
W: 2000 mm < 8000 mm  
P: 1134 mm < 6032 mm

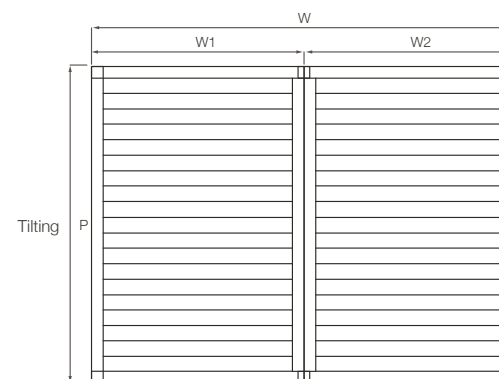
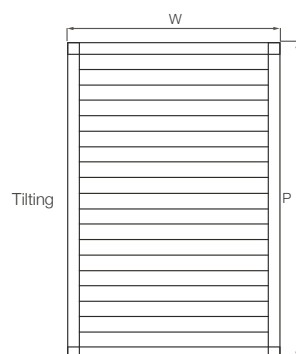
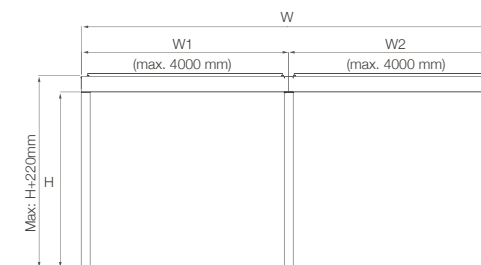
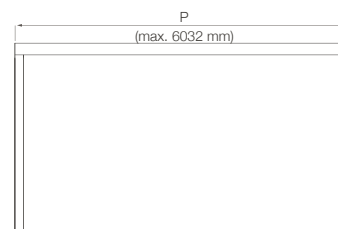
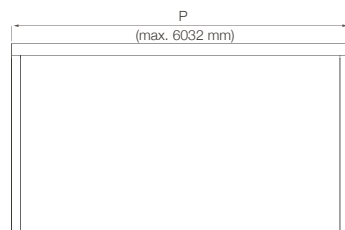
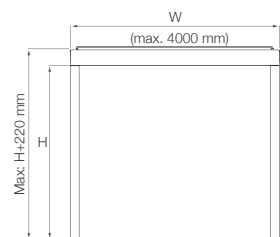

Multiple Modules Joining Type 2  
W: 1000 mm < 4000 mm  
P: 2268 mm < 12064 mm

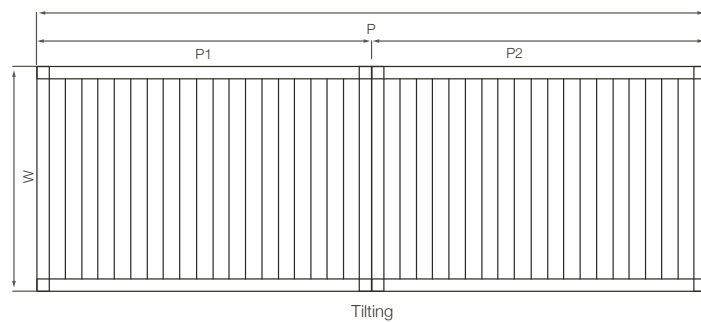
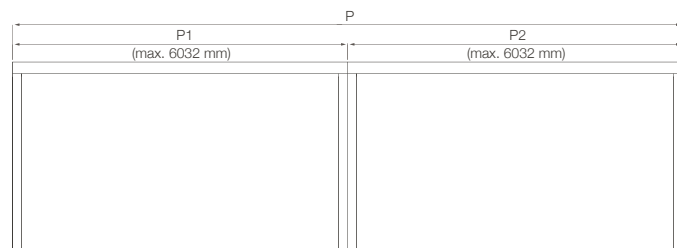
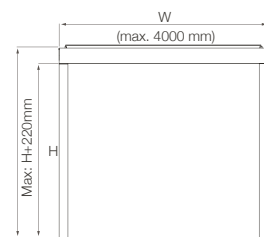

## Technical Details



Max. width for single module	4000 mm
Max. projection single module	6032 mm
Rafter profile dimension	120x220 mm
Post dimension	120x120 mm
Louvre dimension	150 mm
Louvre quantity in max. size	37 pcs
Louvre can be tilted up to	90°

Automation	included
Control unit	included
Led Stripe Dimmer lighting	optional
RGB Led - Hidden Stripe lighting	optional
Insulation foam	N/A
Edge cover profile	N/A
Drainage pipe	optional
Flange	optional
Rain Sensor	optional
Wind Sensor	optional

## Technical Specifications Rota

Technological Outdoor Covering System  
With Rotating Louvres.

### Description

Rota is an ideal technological outdoor covering system for creating outdoor living spaces along with its rotational louvre movement.

### Dimensions

#### One module

**Width** 1000 mm < 4000 mm

**Projection** 1134 mm < 6032 mm

**Column Height** 3000 mm

- Blocked assembly for customized modules with a wide range of flexible combinations.

### Technical Characteristics

- Extruded aluminium frame, blades & gutters - clean edges.
- Electrostatic powder-coated frame.
- High-quality aluminum extrusion profiles (Aluminium Alloy 6063-T6).
- Concealed screws to offer clean finish.
- High grade stainless steel connection components.
- Large span with 4000mm dimension.
- Remote control for operation of mechanism and lighting.
- Invisible 15 mm slope on louvres for maximum water flow efficiency.
- Adjustable louvres for any position within the 90° range.
- Dimmer option to adjust lux intensity.
- Air and water insulation between joining axis of multiple applications is provided by U profile.
- Applicability of guillotine, sliding / sliding frame / folding glass and zip systems.
- Fully waterproof coverage when louvres are in fully closed position.
- Functional seal integration on louvre channel to prevent water leaking and provide extra insulation.
- Seal integration along structure for water insulation and temperature resistance.



- The water is flowed down to the main gutters by special drainage channels along the louveres and drained through columns.
- Internal rainwater down-pipe for columns.
- IP68 protection class, 12/24VDC power supplied linear actuator motor with stainless steel piston rod that enables the louver to rotate.
- Production in compliance with CE, ISO 9001, ISO 1400 and NVA standards.
- In addition to standart RAL colors, Exclusive and Texture range aluminium.
- Functional louver lay out in parallel or vertical position to wall.

## II | Profile Section Dimensions

<b>Rafter / Gutter</b>	: 120 mm x 220 mm x 2,5 mm
<b>Column</b>	: 120 mm x 120 mm x 2,5 mm
<b>Louvre</b>	: 206 mm x 50 mm x 1,8 mm

## III | Installation Methods

- Individual modules can be customised according to specified finish up to 4000mm width and 6032mm projection with flexible installation methods such as integration into existing frameworks, wall mounting and free standing for larger outdoor areas.
- System can be assembled as single or multiple modules.

## IV | Columns

- Dimensions: 120 x 120 mm x 2,5 mm
- Simple column assembly.
- The column cap profile can be pulled out simply and inner column cavity conceals the wiring cables of heater, speaker or automation to provide pure appearance.
- 3 different column base options: Hidden, Flange, Flange With Cover Cap.

## V | Weather Resistance

### Wind Resistance

- Wind rating up to Beaufort number 10 (up to 102km/h).

### Water Drainage

- The four sided gutter for completely ensured waterproofness.
- Optional PVC pipe (Ø45) integration inside columns.
- Customised drain points flexibility.

## VI | Additional Equipments

- Heater, speaker or other automations can be integrated into the system.
- Rain and wind sensor can be adapted.

Rain sensor closes the blades automatically when it rains.

The blades should be closed when wind speed reaches to 102 km/hour to save under warranty terms.

## VII | LED Lighting

Integrated RGB-Led Hidden Stripe and Led Stripe Dimmer Lighting on sides within the structure.

### - Led Stripe Dimmer Lighting

Cool White, 60 LEDs/m I +5100-6500K I 1130 lumens/m

Day Light, 120 LEDs/m I +2800-3500K I 1094 lumens/m

### - RGB Led-Hidden Stripe Lighting

96 LEDs/m

## VIII | Sensors

Wind and rain sensors can be adapted for an optimum level of comfort. These smart sensors are designed to respond fully automatic based on weather conditions in a specific situation. It functions as a protection against unexpected weather conditions.

Sensors will activate an automated system that close/retract the roof and protect the furniture & underneath of covered area even if you are not able to control the system.

### Wind sensor

Wind sensor monitors the gust of wind then retract your outdoor product to protect it against unexpected strong winds and offers constant protection.

The wind speed and lux value required to do this is set directly at the sensor. If the wind picks up significantly wind sensor will close the roof depending on a pre-set wind speed. Thanks to ease of installation and minimal cabling it can be setup simply.

### Rain sensor

Rain sensor will automatically detect the rain and close your roof to prevent raindrops falling through open roof systems even if you are not able to control the system.

If rain is detected the pergola will be closed and the remote control will be needed to open it back.

## IX | Closures

Systems can be completely enclosed with Sapphire automatic vertical glass system, Swind windbreaker system, Violet, Framee, Slidia or motorised Vertex zip for further protection from the elements.

### Sapphire

Sapphire is an automatic vertical guillotine glass system enriched with patented worm shaft technology.

- Systems can incorporate framed tempered 8 mm and 10 mm single or 4mm+12mm+4mm / 5mm+10mm+5mm double insulated glazing.
- Optional 2 or 3 panels configurations are available up to 4 meters width and 3 meters height or 3 meters width and 3,5 meters height.
- Electrostatic powder-coated frame.
- Operation is motorised.
- Upwards or downwards parking position options.
- Fixed panels can be used as balustrades.
- The position of movable panels can be adjusted according to desired height.
- Thanks to strengthened counterweight movement mechanism motor provides balanced&silent up/down operation.
- Fully hidden motor drive.
- Switch, remote or smart home control availability.
- Fine frames with thermal and sound insulated rubber seals.
- Wide open view with up to 4 meters width vertical glass panels.

### Swind

Swind is an automatic vertical up-down glass panel.

- Electrostatic powder-coated frame.
- Extruded aluminium fix panel frame.
- Concealed screws to offer clean finish.
- Horizontal counterweight for smooth motion.
- High strength belt mechanism for balanced movement.
- 10mm fixed and 8mm up-down automatic moveable tempered glass panels.
- Frameless moveable glass panel for unobstructed view.
- Led stripe dimmer lighting integrated side frame / invisible electrical cables.
- Remote control for operation of mechanism and lighting.
- Fast opening-closing cycle.
- Fully hidden compact direct drive motor system.
- Ease of installation with single or multiple modules.
- Portability with optional wheel integration.

- Availability of usage as balustrade in closed position.
- Transparent panels in standards besides Smoked, Green, Blue and Bronze color options.

### Violet

Violet glass balustrade system.

- Concealed screws to offer clean finish.
- Glass fixed pane is 8+1.52 pvb+8mm.
- Led stripe dimmer lighting integrated integrated underneath the glass / invisible electrical cables.
- Remote control for operation of lighting.
- Ease of installation with single or multiple modules.
- Availability of usage as Hand Rail (Optional).
- Compact & Easy Assembly.
- Transparent panels in standards besides Smoked, Green, Blue and Bronze color options.

### Framee

Framee, sliding glass system with fine-framed double glazed panels.

- Double insulated glass (6+12+6mm).
- Transparent sliding glass panels in standard besides of Blue, Green, Smoked and Bronze glass color options.
- Electrostatic powder-coated frame.
- Handle with Click Lock on first panel and Handle with Hidden Lock on the last panel on internal side of sliding panels for security measures.
- Combination availability with Vertex Zip System for sun protection.
- Available with 2,3 or 4 rails up to maximum 8 panels combined with side or central openings.
- Natural, stainless steel and black anodise color options.

### Slidia

Slidia is a sliding glass system with individual parallel glass panels.

- Electrostatic powder-coated frame.
- Features slim aluminum glass profiles.
- Individual panels can be moved horizontally with single or double slide options.
- Bottom wheel carriages with double rollers ensure optimum and smooth running even with wide glass panels.
- Successive panels can be moved by the grap mechanism.
- Height adjustable wheel carriages up to 5mm.
- Sloped rail design for efficient drainage.
- Anodised bottom rail for easy and smooth movement.
- Rain and wind resistance by double sided transparent gaskets (standard), transparent gaskets with brush or aluminum slats with

- brush.
- Brush and rubber cord for high frame insulation.
- Anti-slip rubber ensures safety passage and also offers ease of rail surface cleaning.
- Transparent sliding glass panels in standard besides of Blue, Green, Smoked and Bronze glass color options.
- Internal or external locking of the sliding panels by optional key lock for security measures.
- Flush Circle and Push & Pull Bar handle types and Allen&Key lock.
- Combination availability with Vertex Zip System for sun protection.
- Available with 3 or 5 rails up to maximum 10 panels, combined with side or central openings.

### Vertex Zip System

- Vertex is a motorised external blind system.
- It provides comfortable shade and protects against the UV rays.
  - The system includes motorised aluminium structure.
  - Each screen has a pair of identical side channels.
  - Entirely powder-coated with stainless steel components.
  - Maximum protection against solar radiation and penetration of heat while preserving the optimal level of natural light in the interior and contact with environment.
  - The production technology of fabrics ensures a high resistance to external influences such as wind or changes in temperature and humidity.

### Doors

#### Glass door

- Frameless hinged and frameless hydraulic glass doors are available.
- Single tempered glass (10mm).
- Available with single panel and double panels (each panel in maximum 1000mm).
- Flush Circle and Push & Pull Bar handle types and Allen&Key lock.
- Transparent panels in standards besides Smoked, Green, Blue and Bronze color options.
- Handle position height can be adjusted as desired (Standard height value is 110cm).
- Allen&Key lock for security.

#### Framed glass door

- Hinged and hydraulic framed glass doors are available.
- Electrostatic powder-coated frame.
- Available with double insulated single panel and double panels (each panel in maximum 1000mm).
- Double insulated glass (4+11+4mm).

- Transparent panels in standards besides Smoked, Green, Blue and Bronze color options.
- Handle position height can be adjusted as desired (Standard height value is 110cm).
- Internal or external locking of the sliding panels by optional key lock for security measures.
- Push & Pull Bar handle types.
- Pull Handle/ Lock.

### Photocell Door

- Aluminum framed automatic glass door.
- Electronic lock.
- Possibility of manual usage in emergency situations.
- Electrostatic powder-coated frame.
- Available in Laminated glass (4+4mm).
- Single panel and double panel options (each panel in maximum 1000mm).
- Fast opening-closing cycle and insulation materials for preserving heat balance between indoor and outdoor.
- Transparent panels in standards besides Smoked, Green, Blue and Bronze color options.
- One side button or double side button and double sided transition control types.

### X | Structure Color Options / Finishes

- The products are available with a wide range of colour options in standard or architectural textured coatings.
- In addition to standard RAL colors, Exclusive and Texture range aluminium colors can be offered.
- QualiMarine and Qualanod finishes are also available beside of Qualicoat finishes.

### XI | Warranty

	Rota	Sapphire	Swind	Violet	Framee	Slidia	Vertex
Structure& Coating	5 years	5 years	5 years	5 years	5 years	5 years	5 years
Motor&Control Units	2 years	2 years	2 years	2 years	2 years	2 years	2 years
Lighting& Control Units	2 years	N/A	2 years	2 years	N/A	N/A	N/A

\*End user and installation defects are not covered.

## Overview

## Operations

Tilting



## Lighting Options

Led Stripe Dimmer Lighting

Cool White



Day Light



RGB Led-Hidden Stripe Lighting



## Installation Types

Self Standing Single Module



Self Standing Multiple Modules



Wall Mounting Single Module



Wall Mounting Multiple Modules



## Sensors

Rain Sensor



Wind Sensor



## Closures

Sapphire



Swind



Violet



Framee



Slidia



Vertex Zip System



**FINNKAIHDIN.**

[www.finnkaihdin.fi](http://www.finnkaihdin.fi)

SUNTECH